

Stamisol® DW – Crosswise installation of insulation

The “Valais” roof

1. **Cross laths**
With joints for nails or screws.
2. **Stamisol® DW laid horizontally or vertically**
Glue the overlaps and connections using the Stamisol® glue.
3. **Crosswise installation of the insulation**
4. **Crosswise installation of the laths**
5. **ABS or Stamisol® SD 70 vapour breaks**
The overlays and connections should be glued using the Stamisol® self-adhesive strips so that the air seal is tight.
If necessary, fix the wall connections using the butyl rubber or, for example, with Sikaflex 11FC.
6. **Wainscoting, miscellaneous materials, panelling.**

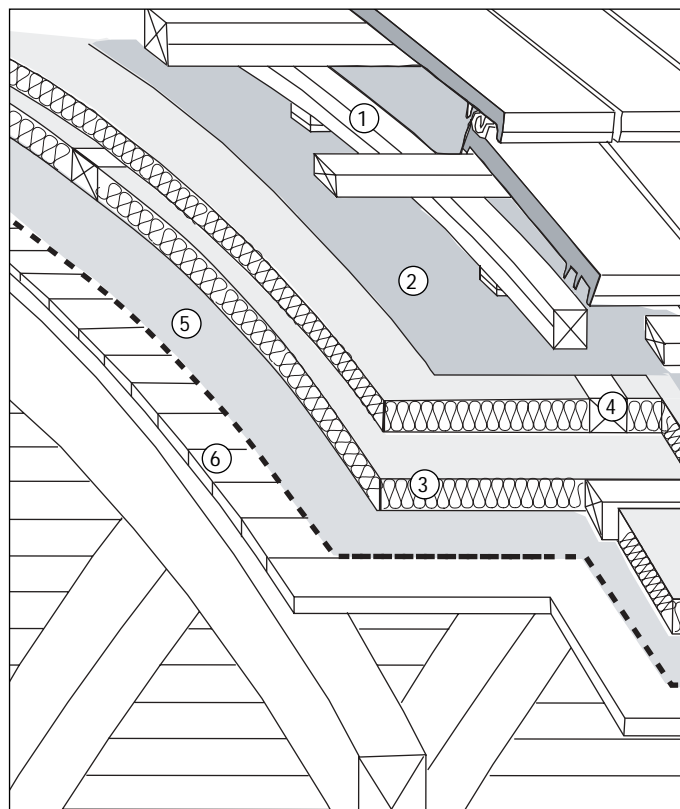

Tender text reference

Stamisol® DW
Pos. 720/721
Pos. 721.171

ABS	SD 70
Pos 520	Pos 530
Pos 524.100	Pos 534.100
Pos 524.112	Pos 534.121

Planning reference

Stamisol® DW can be installed and glued both horizontally and vertically.

Installation instructions

The instruction specifications must be respected.

The roof's load borne by the roofing structure (depending on the building) should be spread across the layers of the sub-construction.

Planning and execution: according to SIA 238
New SIA 232

